

8000 Series

LIVING QUARTERS

Whether you trail ride, rodeo, or show livestock, Sundowner strives to make your living quarters a home away from home that greets you with comfort when returning from a long day. From affordable, lightweight convenience packages, to small weekenders, to mid-sized living quarters, all the way up to the pinnacle of fine living with a multiple slide-out model, Sundowner offers something for everyone. Every living quarters is carefully crafted with the same attention to detail and quality that you deserve and expect. Sundowner is one of the



INTERIOR STANDARD FEATURES

- 15,000 BTU a/c with heat strip
- 3 cu. ft. gas/electric or 8 cu. ft. 12v refrigerator
- Microwave
- Formica counter tops
- Single bowl kitchen sink
- Swivel TV antenna
- AM/FM Radio CD/DVD player with inside & outside speakers
- Day/night shades
- Mattress
- Quilt
- Wardrobe and linen closet (per plan)
- Ceiling puck lights
- Retractable shower door
- Towel rack ring and toilet paper holder
- Toilet
- Shower
- USB Ports
- Grab handle
- Furnace with (2) 20lb tanks
- 12 volt demand water pump
- City water hook up
- 31 gallon black water tank
- 31 gallon gray water tank
- Sewer dump hose and storage compartment
- 6 gallon LP gas/electric water heater with automatic recovery
- Water drains and water heater bypass for easy winterizing
- Heavy duty 65 amp 12 volt power converter battery charger
- 30 amp marine style 30ft power cord lifeline
- 12 volt charge line to truck
- 12 volt battery disconnect switch
- (2) Deep cycle batteries
- 120 volt kitchen and bathroom receptacles, GFI protected
- LP gas leak detector
- Emergency exit windows
- Smoke alarm and fire extinguisher

TRAILER STANDARD EQUIPMENT

- 2 5/16" Gooseneck hitch, adjustable
- 8' Wide
- 7'6" Tall
- Slant load
- 2 to 8 Horse
- 39" Wide stalls
- All aluminum construction
- All aluminum floors
- Tube frame wall with integrated roof rail
- Prepainted aluminum skin top half, extruded aluminum sides lower half
- 2 Rubber torsion axles

- 4 Wheel electric brakes/safety breakaway
- Aluminum wheels
- Radial tires
- Rear rubber bumper
- LED clearance and 4 Tail lights with switch for operating lights while parked
- Drop leg jack (Hydraulic jack on 11' & up models)
- Double battery box with 2 batteries on 11' & up models

HORSE AREA STANDARD EQUIPMENT

- Air flowdiver(s) with pads
- Floor mats in horse area
- Drop down feed door with sliding window per stall behind first
- First stall access door with window, cam latch and black latch
- Feed manger with access door on all stalls behind the first stall
- 2 Air gaps with Plexiglas on rump side
- 48" SunCoat™ entire horse area
- Double rear doors with Plexiglas on load side door, solid rear tack door
- Horse vent per stall
- Dome light in horse area
- 2 Inside/1 outside tie ring per stall
- Telescoping rear divider
- Collapsible rear tack with saddle rack, tack hooks and dome light
- Porch light

POPULAR OPTIONS

- Skin colors: white, black, silver, charcoal, and champagne
- Additional dome lights
- Load lights
- Aluminum face guard
- Rear ramp
- Awning
- Hay rack
- Round shower
- Pocket door to bathroom
- Skylight dome in shower
- Stainless nose wrap
- Weld on hinge package
- Rump side window package/model (window per stall on rump side and a window in the load side rear door)

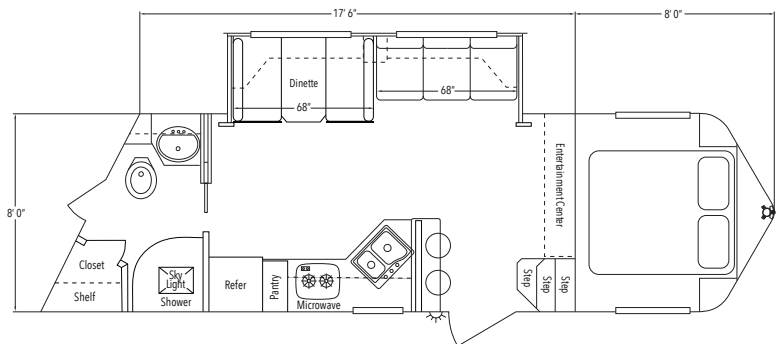
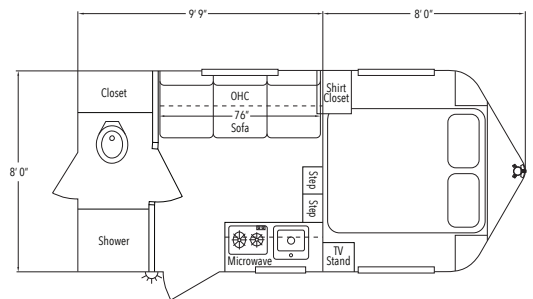

All dimensions are approximate. Photos may show options. Due to constant product improvements, specifications, component parts, standard and optional equipment are subject to change without notice or obligation. Refer to standard and special features for specifics. See your dealer for warranty details. 2024 © Sundowner Trailers, Inc. (10.15.24)

SUNDOWNER TRAILERS, INC.

9805 OK Highway 48 South • Coleman, Oklahoma 73432-8523

800-438-4294 • sundownertrailer.com